

**CERTIFICATION**

2017 JUN 21 PM 2: 30

**Consumer Confidence Report (CCR)**

Pine Haven Mobile Home Village

Public Water Supply Name

0240195

List PWS ID #s for all Community Water Systems included in this CCR

The Federal Safe Drinking Water Act (SDWA) requires each Community public water system to develop and distribute a Consumer Confidence Report (CCR) to its customers each year. Depending on the population served by the public water system, this CCR must be mailed or delivered to the customers, published in a newspaper of local circulation, or provided to the customers upon request. Make sure you follow the proper procedures when distributing the CCR. **You must mail, fax or email a copy of the CCR and Certification to MSDH. Please check all boxes that apply.**

Customers were informed of availability of CCR by: *(Attach copy of publication, water bill or other)*

- Advertisement in local paper (attach copy of advertisement)
- On water bills (attach copy of bill)
- Email message (MUST Email the message to the address below)
- Other Posted on community bulletin board

Date(s) customers were informed: \_\_\_ / \_\_\_ / \_\_\_ , \_\_\_ / \_\_\_ / \_\_\_ , \_\_\_ / \_\_\_ / \_\_\_

CCR was distributed by U.S. Postal Service or other direct delivery. Must specify other direct delivery methods used \_\_\_\_\_

Date Mailed/Distributed: \_\_\_ / \_\_\_ / \_\_\_

CCR was distributed by Email (MUST Email MSDH a copy)

Date Emailed: \_\_\_ / \_\_\_ / \_\_\_

- As a URL (Provide URL \_\_\_\_\_)
- As an attachment
- As text within the body of the email message

CCR was published in local newspaper. *(Attach copy of published CCR or proof of publication)*

Name of Newspaper: \_\_\_\_\_

Date Published: \_\_\_ / \_\_\_ / \_\_\_

CCR was posted in public places. *(Attach list of locations)*Date Posted: 6/19/17CCR was posted on a publicly accessible internet site at the following address (**DIRECT URL REQUIRED**):**CERTIFICATION**

I hereby certify that the **Consumer Confidence Report (CCR)** has been distributed to the customers of this public water system in the form and manner identified above and that I used distribution methods allowed by the SDWA. I further certify that the information included in this CCR is true and correct and is consistent with the water quality monitoring data provided to the public water system officials by the Mississippi State Department of Health, Bureau of Public Water Supply

Ashley Spangberg, Asset Manager  
Name/Title (President, Mayor, Owner, etc.)

6/19/17  
Date

**Submission options (Select one method ONLY)**

**Mail:** (U.S. Postal Service)  
MSDH, Bureau of Public Water Supply  
P.O. Box 1700  
Jackson, MS 39215

**Fax:** (601) 576 - 7800

**Email:** [water.reports@msdh.ms.gov](mailto:water.reports@msdh.ms.gov)

**CCR Deadline to MSDH & Customers by July 1, 2017!**



NO CASH PLEASE

**Time to Refer a Friend Today**

Refer a qualified friend who knows you better than you know yourself. Your referral fee is \$100.00 and your friend's referral fee is \$100.00.

Call Kimberley, Property Manager  
**(228) 392-0510**

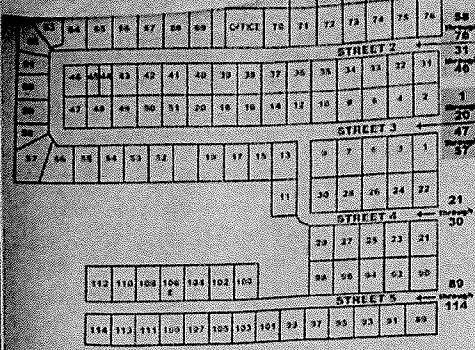

**Haven Mobile Home Park**

*It's Slime Time!*

FUN COPIES LOCATED IN OFFICE

**MAY NEWSLETTER**

Spring is in full bloom! We had an "It's Slime Time" event at Haven Mobile Home Park. The kids had a wonderful time with parents, teachers, and friends. We had a great time with a full day of fun activities and a delicious lunch.



Let's take advantage of this beautiful weather we have and get out in the woods to enjoy a "Company" of friends. We had a great time with a full day of fun activities and a delicious lunch.

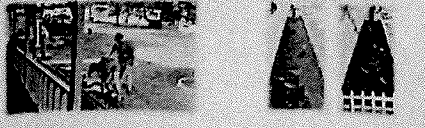

**2015 Annual Drinking Water Quality Report**  
Pine Haven Mobile Home Village  
Pine Haven, MO 64675  
June 2015

This report is prepared to give the year's Annual Drinking Water Quality Report. This report is prepared to inform you about the quality of the water you drink and the safety of the water you use. The water you drink is safe to drink and is of excellent quality. The water you use is safe to use and is of excellent quality.

The water quality report has been prepared to inform you about the quality of the water you drink and the safety of the water you use. The water you drink is safe to drink and is of excellent quality. The water you use is safe to use and is of excellent quality.

At the time you will find many items and information you might not find elsewhere. To help you better understand these items we provide the following information:

**Action Level:** The concentration of a contaminant which, if exceeded, triggers treatment of that contaminant which is more rigorous than the Maximum Contaminant Level (MCL). The Maximum Contaminant Level (MCL) is the highest level of a contaminant that is allowed in drinking water. MCLs are set to protect the public health over the long-term (10 years or longer).

**Maximum Contaminant Level Goal (MCLG):** The "ideal" MCLG is the level of a contaminant in drinking water below which there is no known or expected risk to health. MCLGs do not reflect the benefits of the use of treatment to control microbial contaminants.

**Maximum Residual Disinfectant Level (MRDL):** The highest level of a disinfectant allowed in drinking water. There is no known or expected risk to health at this level. MCLGs do not apply to disinfectants.

**Maximum Allowable Disinfectant Level (MADL):** The level of a disinfectant which is allowed in drinking water which is known to be safe for health. MADLs do not reflect the benefits of the use of treatment to control microbial contaminants.

Each year, we test for 19 different contaminants. We test for 19 different contaminants to ensure you are getting the best quality water possible. We test for 19 different contaminants to ensure you are getting the best quality water possible.

TEST RESULTS									
Contaminant	Violation	Unit	Level	Range of Detection	Unit	MCL	MCLG	MRDL	MRDLG
<b>Inorganic Contaminants</b>									
18 Arsenic	A	ppb	0.02	Not Report	ppm	10	5	10	5
19 Cadmium	A	ppb	1	Not Report	ppm	100	100	100	100
14 Copper	A	ppm	2	2	ppm	1.3	1.3	1.3	1.3

NO CASH PLEASE



68	69	70	71	72	73	74	75	76	77	78	79	80	81	82
83	84	85	86	87	88	89	90	91	92	93	94	95	96	97
98	99	100	101	102	103	104	105	106	107	108	109	110	111	112
113	114	115	116	117	118	119	120	121	122	123	124	125	126	127
128	129	130	131	132	133	134	135	136	137	138	139	140	141	142
143	144	145	146	147	148	149	150	151	152	153	154	155	156	157
158	159	160	161	162	163	164	165	166	167	168	169	170	171	172
173	174	175	176	177	178	179	180	181	182	183	184	185	186	187
188	189	190	191	192	193	194	195	196	197	198	199	200	201	202

Call Kimberly, Property  
(228) 392-0

Haven Mobile Home Park

It's Slime Time!

FUN CLIP

Copies Located In Office

MAJ NEWSLETTER

hent

2019 Annual Drinking Water Quality Report  
Pine Island, Mobile Bay, Florida  
Page 2 (2/27/19)  
June 2019

As a provider of water to you, we are committed to providing you with the highest quality water possible. This report is designed to provide you with information on the quality of the water you receive from the water utility. The information in this report is intended to provide you with a better understanding of the water quality and the processes used to treat the water. The information in this report is intended to provide you with a better understanding of the water quality and the processes used to treat the water.

**TEST RESULTS**

Parameter	Units	Value	Units	Value	Units	Value	Units	Value
Iron	mg/L	0.15	mg/L	0.15	mg/L	0.15	mg/L	0.15
Copper	mg/L	0.05	mg/L	0.05	mg/L	0.05	mg/L	0.05
Lead	ppb	1	ppb	1	ppb	1	ppb	1
Chlorine	mg/L	2.5	mg/L	2.5	mg/L	2.5	mg/L	2.5
Chlorine	mg/L	2.5	mg/L	2.5	mg/L	2.5	mg/L	2.5

**Inorganic Contaminants**

Parameter	Units	Value	Units	Value	Units	Value	Units	Value
Iron	mg/L	0.15	mg/L	0.15	mg/L	0.15	mg/L	0.15
Copper	mg/L	0.05	mg/L	0.05	mg/L	0.05	mg/L	0.05
Lead	ppb	1	ppb	1	ppb	1	ppb	1
Chlorine	mg/L	2.5	mg/L	2.5	mg/L	2.5	mg/L	2.5
Chlorine	mg/L	2.5	mg/L	2.5	mg/L	2.5	mg/L	2.5



We're pleased to present to you this year's Annual Quality Water Report. This report is designed to inform you about the quality water and services we deliver to you every day. Our constant goal is to provide you with a safe and dependable supply of drinking water. We want you to understand the efforts we make to continually improve the water treatment process and protect our water resources. We are committed to providing you with information because informed customers are our best allies. Our water source is from wells drawing from the Graham's Ferry Aquifer.

The source water assessment has been completed for our public water system to determine the overall susceptibility of its drinking water supply to identify potential sources of contamination. A report containing detailed information on how the susceptibility determinations were made has been furnished to our public water system and is available for viewing upon request. The wells for the Pine Haven Mobile Home Village have received lower rankings in terms of susceptibility to contamination.

If you have any questions about this report or concerning your water utility, please contact Kimberly Woodward at 228.297.3540. We want our valued customers to be informed about their water utility. Report will be posted on bulletin board at office.

We routinely monitor for contaminants in your drinking water according to Federal and State laws. The table below lists all of the drinking water contaminants that were detected during the period of January 1<sup>st</sup> to December 31<sup>st</sup>, 2018. In cases where monitoring wasn't required in 2018, the table reflects the most recent results. As water travels over the surface of land or underground, it dissolves naturally occurring minerals and, in some cases, radioactive materials and can pick up substances or contaminants from the presence of animals or from human activity. Microbial contaminants, such as viruses and bacteria, that may come from sewage treatment plants, septic systems, agricultural livestock operations, and wildlife. Inorganic contaminants, such as salts and metals, which can be naturally occurring or result from urban storm-water runoff, industrial, or domestic wastewater discharges, oil and gas production, mining, or farming; pesticides and herbicides, which may come from a variety of sources such as agriculture, storm-water runoff, and residential uses; organic chemical contaminants, including synthetic and volatile organic chemicals, which are by-product of industrial processes and petroleum production, and can also come from gas stations and septic systems; radioactive contaminants, which can be naturally occurring or be the result of oil and gas production and mining activities. In order to ensure that tap water is safe to drink, EPA prescribes regulations that limit the amount of certain contaminants in water provided by public water systems. All drinking water, including bottled drinking water, may be reasonably expected to contain at least small amounts of some contaminants. It's important to remember that the presence of these contaminants does not necessarily indicate that the water poses a health risk.

In this table you will find many terms and abbreviations you might not be familiar with. To help you better understand these terms we've provided the following definitions.

**Action Level** - the concentration of a contaminant which, if exceeded, triggers treatment or other requirements which a water system must follow.

**Maximum Contaminant Level (MCL)** - The "Maximum Allowed" (MCL) is the highest level of a contaminant that is allowed in drinking water. MCLs are set as close to the MCLGs as feasible using the best available treatment technology.

**Maximum Contaminant Level Goal (MCLG)** - The "Goal" (MCLG) is the level of a contaminant in drinking water below which there is no known or expected risk to health. MCLGs allow for a margin of safety.

**Maximum Residual Disinfectant Level (MRDL)** - The highest level of a disinfectant allowed in drinking water. There is convincing evidence that addition of a disinfectant is necessary for control microbial contaminants.

**Maximum Residual Disinfectant Level Goal (MRDLG)** - The level of a drinking water disinfectant below which there is no known or expected risk to health. MRDLGs do not reflect the benefits of the use of disinfectants to control microbial contaminants.

**Parts per million (ppm) or Milligrams per liter (mg/l)** - one part per million corresponds to one minute in two years or a single penny in \$10,000,000.

**Parts per billion (ppb) or Micrograms per liter** - one part per billion corresponds to one minute in 2,000 years, or a single penny in \$10,000,000,000.

## TEST RESULTS

Contaminant	Violation Y/N	Date Collected	Level Detected	Range of Detects or # of Samples Exceeding MCL/ACL/MRDL	Unit Measurement	MCLG	MCL	Usual Source of Contamination
<b>Inorganic Contaminants</b>								
10. Barium	N	2015*	.0272	No Range	ppm	2	2	Discharge of drilling water; discharge from coal refineries; erosion of natural deposits
13. Chromium	N	2015*	2	No Range	ppb	100	100	Discharge from steel and pulp mills; erosion of natural deposits
14. Copper	N	2012/14*	.2	0	ppm	1.3	AL=1.3	Corrosion of household plumbing systems; erosion of natural deposits; leaching from wood preservatives

2016 Annual Drinking Water Quality Report  
 Pine Haven Mobile Home Village  
 PWS#: 0240195  
 June 2017

2017 JUN 19 AM 8:54

We're pleased to present to you this year's Annual Quality Water Report. This report is designed to inform you about the quality water and services we deliver to you every day. Our constant goal is to provide you with a safe and dependable supply of drinking water. We want you to understand the efforts we make to continually improve the water treatment process and protect our water resources. We are committed to providing you with information because informed customers are our best allies. Our water source is from wells drawing from the Grahams Ferry Aquifer.

The source water assessment has been completed for our public water system to determine the overall susceptibility of its drinking water supply to identify potential sources of contamination. A report containing detailed information on how the susceptibility determinations were made has been furnished to our public water system and is available for viewing upon request. The wells for the Pine Haven Mobile Home Village have received lower rankings in terms of susceptibility to contamination.

If you have any questions about this report or concerning your water utility, please contact Kimberly Woodward at 228.392.0510. We want our valued customers to be informed about their water utility. Report will be posted on bulletin board at office.

We routinely monitor for contaminants in your drinking water according to Federal and State laws. This table below lists all of the drinking water contaminants that were detected during the period of January 1<sup>st</sup> to December 31<sup>st</sup>, 2016. In cases where monitoring wasn't required in 2016, the table reflects the most recent results. As water travels over the surface of land or underground, it dissolves naturally occurring minerals and, in some cases, radioactive materials and can pick up substances or contaminants from the presence of animals or from human activity; microbial contaminants, such as viruses and bacteria, that may come from sewage treatment plants, septic systems, agricultural livestock operations, and wildlife; inorganic contaminants, such as salts and metals, which can be naturally occurring or result from urban storm-water runoff, industrial, or domestic wastewater discharges, oil and gas production, mining, or farming; pesticides and herbicides, which may come from a variety of sources such as agriculture, urban storm-water runoff, and residential uses; organic chemical contaminants, including synthetic and volatile organic chemicals, which are by-products of industrial processes and petroleum production, and can also come from gas stations and septic systems; radioactive contaminants, which can be naturally occurring or be the result of oil and gas production and mining activities. In order to ensure that tap water is safe to drink, EPA prescribes regulations that limit the amount of certain contaminants in water provided by public water systems. All drinking water, including bottled drinking water, may be reasonably expected to contain at least small amounts of some contaminants. It's important to remember that the presence of these contaminants does not necessarily indicate that the water poses a health risk.

In this table you will find many terms and abbreviations you might not be familiar with. To help you better understand these terms we've provided the following definitions:

*Action Level* - the concentration of a contaminant which, if exceeded, triggers treatment or other requirements which a water system must follow.

*Maximum Contaminant Level (MCL)* - The "Maximum Allowed" (MCL) is the highest level of a contaminant that is allowed in drinking water. MCLs are set as close to the MCLGs as feasible using the best available treatment technology.

*Maximum Contaminant Level Goal (MCLG)* - The "Goal"(MCLG) is the level of a contaminant in drinking water below which there is no known or expected risk to health. MCLGs allow for a margin of safety.

*Maximum Residual Disinfectant Level (MRDL)* - The highest level of a disinfectant allowed in drinking water. There is convincing evidence that addition of a disinfectant is necessary for control microbial contaminants.

*Maximum Residual Disinfectant Level Goal (MRDLG)* - The level of a drinking water disinfectant below which there is no known or expected risk of health. MRDLGs do not reflect the benefits of the use of disinfectants to control microbial contaminants.

*Parts per million (ppm) or Milligrams per liter (mg/l)* - one part per million corresponds to one minute in two years or a single penny in \$10,000.

*Parts per billion (ppb) or Micrograms per liter* - one part per billion corresponds to one minute in 2,000 years, or a single penny in \$10,000,000.

TEST RESULTS								
Contaminant	Violation Y/N	Date Collected	Level Detected	Range of Detects or # of Samples Exceeding MCL/AQL/MRDL	Unit Measure -ment	MCLG	MCL	Likely Source of Contamination
<b>Inorganic Contaminants</b>								
10. Barium	N	2015*	.0272	No Range	ppm	2	2	Discharge of drilling wastes; discharge from metal refineries; erosion of natural deposits
13. Chromium	N	2015*	2	No Range	ppb	100	100	Discharge from steel and pulp mills; erosion of natural deposits
14. Copper	N	2012/14*	.2	0	ppm	1.3	AL=1.3	Corrosion of household plumbing systems; erosion of natural deposits; leaching from wood preservatives

16. Fluoride	N	2015*	.173	No Range	ppm	4	4	Erosion of natural deposits; water additive which promotes strong teeth; discharge from fertilizer and aluminum factories
17. Lead	N	2012/14*	4	0	ppb	0	AL=15	Corrosion of household plumbing systems, erosion of natural deposits
<b>Disinfection By-Products</b>								
81. HAA5	N	2014*	1	No Range	ppb	0	60	By-Product of drinking water disinfection.
Chlorine	N	2016	1.1	.4 – 1.4	mg/l	0	MRDL = 4	Water additive used to control microbes

\* Most recent sample. No sample required for 2016.

#### Significant Deficiencies

During a sanitary survey conducted on 3/25/2015, the Mississippi State Department of Health cited the following significant deficiency(s).

Inadequate follow up on previous deficiencies

During a sanitary survey conducted on 2/28/2012, the Mississippi State Department of Health cited the following significant deficiency(s).

- 1) Inadequate security measures
- 2) Improperly constructed well (ex. Not properly grouted)
- 3) Lack of redundant mechanical components where treatment is required
- 4) Improper recordkeeping
- 5) Not monitoring according to site sampling plan or monitoring plan
- 6) No approved emergency response plan or vulnerability analysis (updated annually)

Corrective actions: MSDH is currently working with this system to return them to compliance since the expiration of the compliance deadline. It is anticipated we will be returned to compliance by 6/30/2017.

If present, elevated levels of lead can cause serious health problems, especially for pregnant women and young children. Lead in drinking water is primarily from materials and components associated with service lines and home plumbing. Our water system is responsible for providing high quality drinking water, but cannot control the variety of materials used in plumbing components. When your water has been sitting for several hours, you can minimize the potential for lead exposure by flushing your tap for 30 seconds to 2 minutes before using water for drinking or cooking. If you are concerned about lead in your water, you may wish to have your water tested. Information on lead in drinking water, testing methods, and steps you can take to minimize exposure is available from the Safe Drinking Water Hotline or at <http://www.epa.gov/safewater/lead>. The Mississippi State Department of Health Public Health Laboratory offers lead testing. Please contact 601.576.7582 if you wish to have your water tested.

All sources of drinking water are subject to potential contamination by substances that are naturally occurring or man made. These substances can be microbes, inorganic or organic chemicals and radioactive substances. All drinking water, including bottled water, may reasonably be expected to contain at least small amounts of some contaminants. The presence of contaminants does not necessarily indicate that the water poses a health risk. More information about contaminants and potential health effects can be obtained by calling the Environmental Protection Agency's Safe Drinking Water Hotline at 1-800-426-4791.

Some people may be more vulnerable to contaminants in drinking water than the general population. Immuno-compromised persons such as persons with cancer undergoing chemotherapy, persons who have undergone organ transplants, people with HIV/AIDS or other immune system disorders, some elderly, and infants can be particularly at risk from infections. These people should seek advice about drinking water from their health care providers. EPA/CDC guidelines on appropriate means to lessen the risk of infection by Cryptosporidium and other microbial contaminants are available from the Safe Drinking Water Hotline 1.800.426.4791.

The Pine Haven Mobile Home Village works around the clock to provide top quality water to every tap. We ask that all our customers help us protect our water sources, which are the heart of our community, our way of life and our children's future.